

frandoli

Schede Tecniche

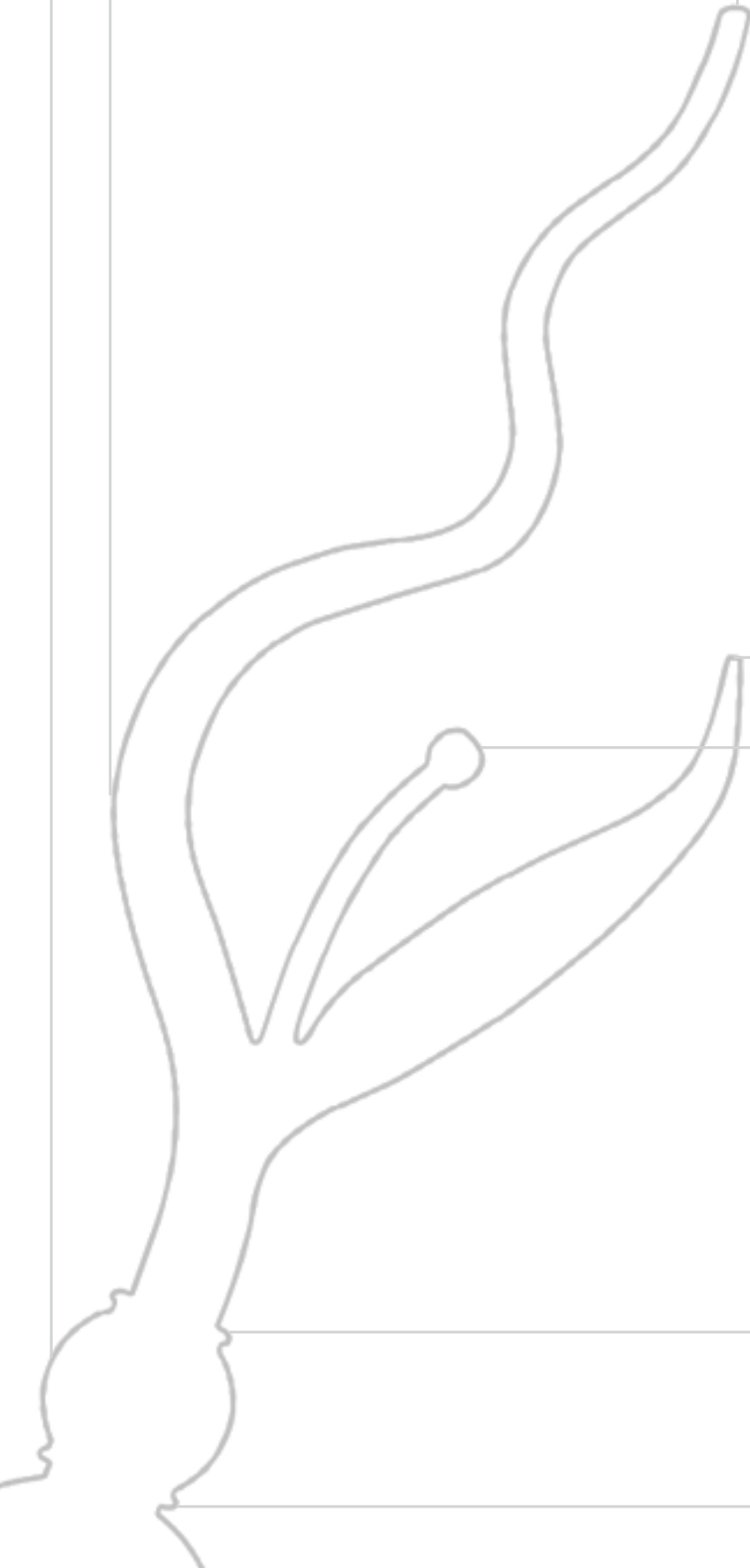

AA102 DENVER

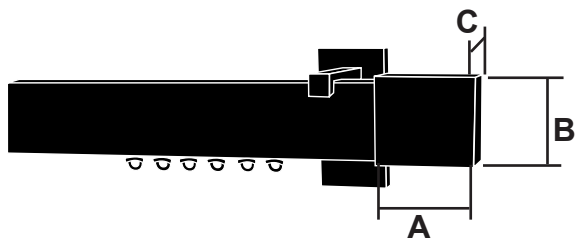

A mm	B mm	C mm
50	45	24

AA10201/02 DENVER T/C

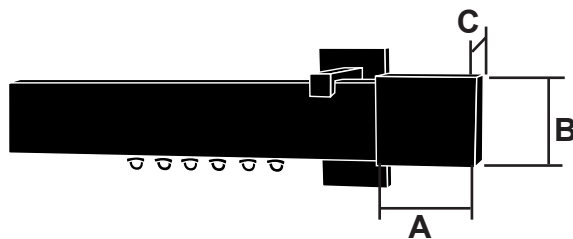

A mm	B mm	C mm
65	47	21

AA105 LINE



TERMINALE/FINIAL	
A mm	B mm
14	20

AA103 SAMANTA



TERMINALE/FINIAL	
A mm	B mm
20	24

AA106 CIRCLE

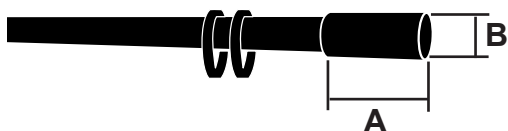

TERMINALE/FINIAL	
A mm	B mm
40	20

AA101 SASHA

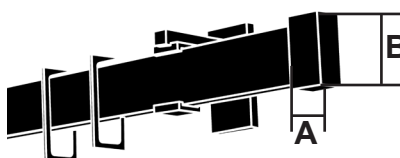

TERMINALE/FINIAL	
A mm	B mm
25	50

AA107 PLANE



TERMINALE/FINIAL	
A mm	B mm
40	20

**AA200 SUPPORTO DENVER
DENVER BRACKET**

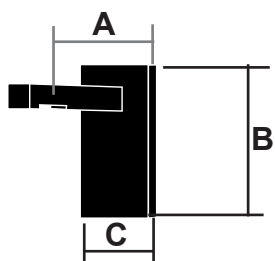

A mm	B mm	C mm
50	80	40
90		
150		
180		
210		

**AA200SF SUPPORTO DENVER SOFFITTO
DENVER CEILING BRACKET**

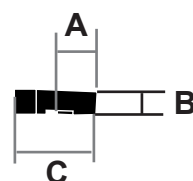

A mm	B mm	C mm
27	12	40

**AA200DP SUPPORTO DENVER DOPPIO
DENVER DOUBLE BRACKET**

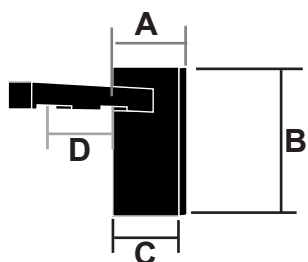

A mm	B mm	C mm	D mm
95	80	40	50

**AA207 SUPPORTO DENVER MULTICANALE
DENVER PANEL BRACKET**

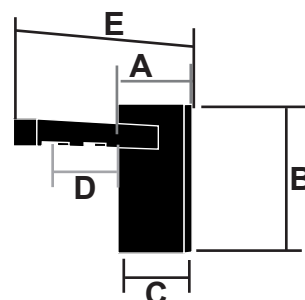

2 canali

A mm	B mm	C mm	D mm	E mm
115	80	40	30	160

**AA207 SUPPORTO DENVER MULTICANALE
DENVER PANEL BRACKET**

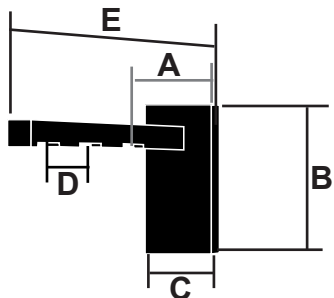

3 canali

A mm	B mm	C mm	D mm	E mm
85	80	40	30	160

**AA207 SUPPORTO DENVER MULTICANALE
DENVER PANEL BRACKET**

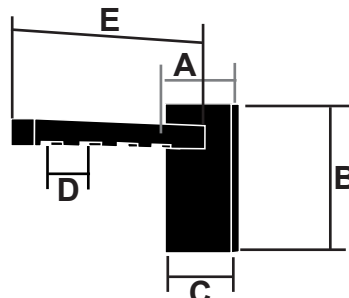

4 canali

A mm	B mm	C mm	D mm	E mm
55	80	40	50	160

**AA207 SUPPORTO DENVER MULTICANALE
DENVER PANEL BRACKET**

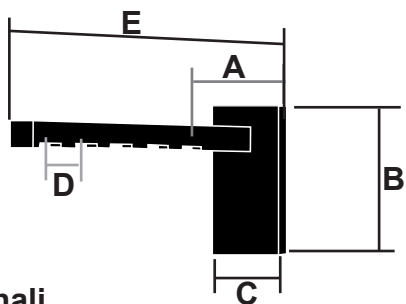

5 canali

A mm	B mm	C mm	D mm	E mm
55	80	40	50	190

**AA206 CLIP A SOFFITTO
CLICK CEILING BRACKET**

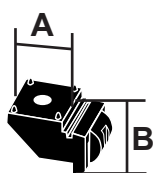

A mm	B mm
17	17

**AA218 SUPP. A SOFFITTO CON LEVA
CEILING BRACKET WITH LEVER**

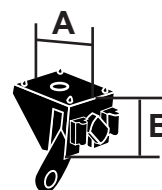

A mm	B mm
21	19

**AA217 SUPP. A SOFFITTO O A PARETE CON LEVA
CEILING OR WALL BRACKET WITH LEVER**

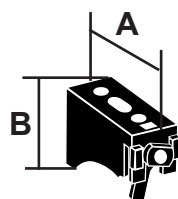

A mm	B mm
55	34

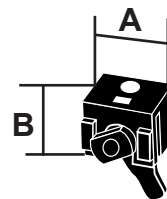

A mm	B mm
31	21

AA202 ROSETTA DENVER CHIUSA
DENVER CLOSED RECESS BRACKET

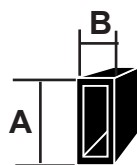

A mm	B mm
46	25

AA203 ROSETTA DENVER APERTA
DENVER OPEN RECESS BRACKET

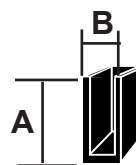

A mm	B mm
46	25

AA205 TAPPO CONGIUNZIONE ANGOLARE
CLASSIC RECESS BRACKET

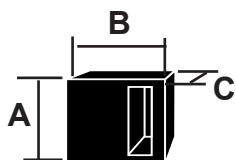

A mm	B mm	C mm
45	50	24

AA204 TAPPO CONGIUNZIONE DENVER
JUNCTION DENVER

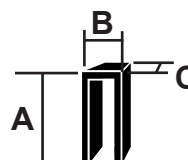

A mm	B mm	C mm
46	25	25

AA240 PROFILO DENVER
DENVER PROFILE



A mm	B mm
40	15

**AA210 SUPPORTO LINE
LINE BRACKET**

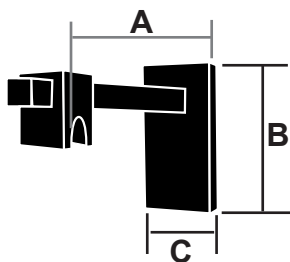

A mm	B mm	C mm
50	80	40
120		
180		
240		

AA213 ADATTATORE LINE

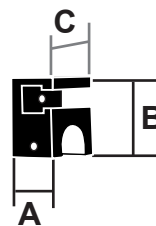

A mm	B mm	C mm
25	37	25

**AA216 SUPPORTO LINE A SOFFITTO
CEILING LINE BRACKET**

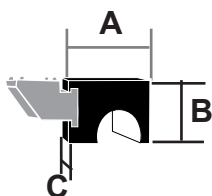

A mm	B mm	C mm
30	25	25

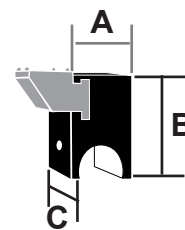

A mm	B mm	C mm
25	37	25

LA209 SUPPORTO ROUND
ROUND BRACKET

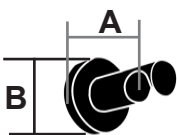

A mm	B mm
60	45
120	
160	
210	

LA210 SUPPORTO ROUND DOPPIO
ROUND BRACKET-DOUBLE

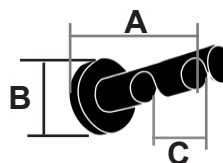

A mm	B mm	C mm
120	45	50
160		
210		

LA209SF SUPPORTO ROUND SOFFITTO
ROUND CEILING BRACKET

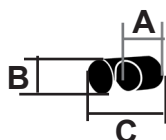

A mm	B mm	C mm
25	24	38

LA207 SUPPORTO SHAPE
SHAPE BRACKET

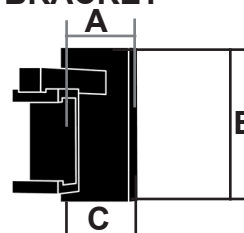

A mm	B mm	C mm
70	80	40
150		
210		

LA207SF SUPPORTO SHAPE SOFFITTO
SHAPE CEILING BRACKET

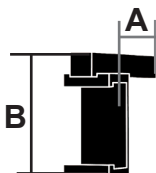

A mm	B mm
40	60

LA207DP SUPPORTO SHAPE DOPPIO
SHAPE BRACKET-DOUBLE

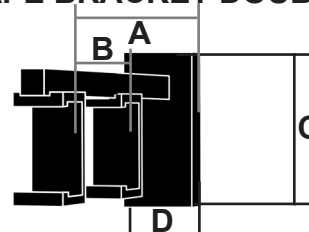

A mm	B mm	C mm	D mm
130	62	80	40

**LA211 ROSETTA CHIUSA
CLOSED RECESS BRACKET**

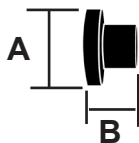

DIAMETRO DIAMETER	A mm	B mm
Ø 18	32	22

**LA212 ROSETTA APERTA
OPEN RECESS BRACKET**

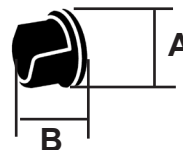

DIAMETRO DIAMETER	A mm	B mm
Ø zzzz	32	22

**LA208 ROSETTA SHAPE
SHAPE RECESS BRACKET**

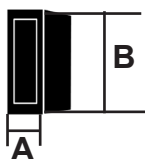

A mm	B mm
25	50

**LA23016 ANELLO SEZIONE PIATTA
FLAT RING**

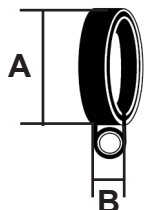

DIAMETRO ASTA ROD DIAMETER	A mm	B mm
Ø 20	35	5

**LA23207 ANELLO RETTANGOLARE
RECTANGULAR RING**

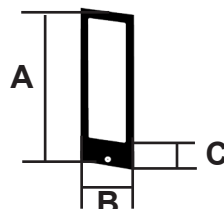

A mm	B mm	C mm
70	30	3

AA241 PROFILO LINE
LINE PROFILE



A mm
18

DP145 PROFILO RETTANGOLARE
RECTANGULAR PROFILE



A mm	B mm
40	15

AA212 TAPPO CONGIUNZIONE LINE APERTA
OPEN JUNCTION LINE



A mm	B mm
21	40

AA212 TAPPO CONGIUNZIONE LINE ANGOLARE
JUNCTION LINE ANGULAR

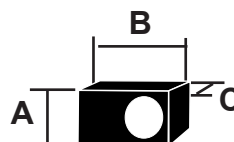

A mm	B mm	C mm
25	41	25

AA282 FIOCCO PER TIRO CORDA
CORD WEIGHT



A mm	B mm
72	20

Linea CASUAL _____ FERMATENDA / CURTAIN STOP

LA113 AXEL

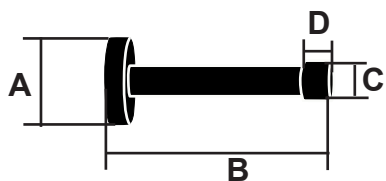

A mm	B mm	C mm	D mm
45	120	24	14
	160		
	210		

AA300 LINE

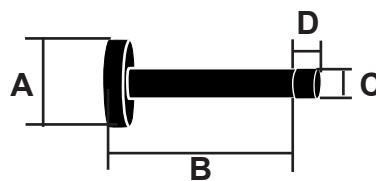

A mm	B mm	C mm	D mm
45	120	20	14
	160		
	210		

AA301 CIRCLE

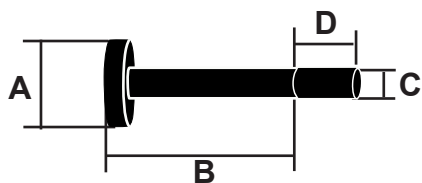

A mm	B mm	C mm	D mm
45	120	20	40
	160		
	210		

AA302 PLANE

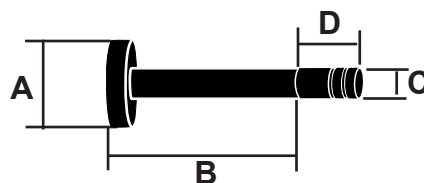

A mm	B mm	C mm	D mm
45	120	20	40
	160		
	210		